

Eye Bearing

to DIN 504

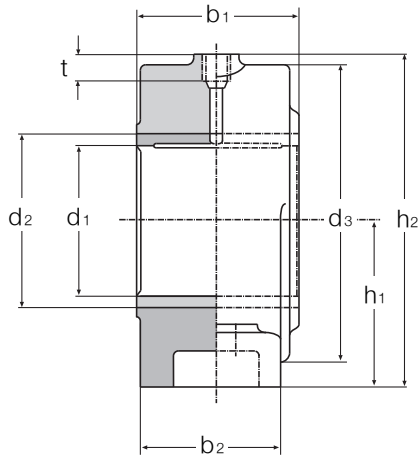

Style A with Bush



Style B without Bush

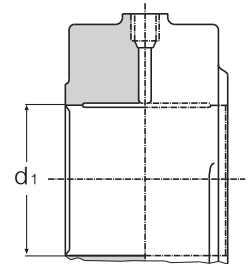
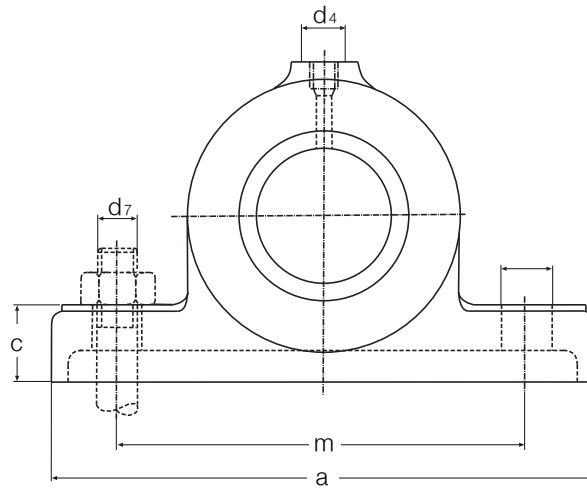

d ₁ / D10 A	d ₁ B	a	b ₁	b ₂	c	d ₂ mm	d ₃	d ₄	d ₆	d ₇	h ₁ +/- 0,2	h ₂ max	m	t
-	20	110	50	35	18	-	45	R ^{1/4}	12	M10	30	56	75	10
-	25	140	60	40	25	-	60	R ^{1/4}	15	M12	40	75	100	10
-	30	140	60	40	25	-	60	R ^{1/4}	15	M12	40	75	100	10
25	35	160	60	45	25	35	80	R ^{1/4}	15	M12	50	95	120	10
30	40	160	60	45	25	40	80	R ^{1/4}	15	M12	50	95	120	10
35	45	190	70	50	30	45	90	R ^{1/4}	19	M16	60	110	140	10
40	50	190	70	50	30	50	90	R ^{1/4}	19	M16	60	110	140	10
45	55	220	80	55	35	55	100	R ^{1/4}	24	M20	70	125	160	10
50	60	220	80	55	35	60	100	R ^{1/4}	24	M20	70	125	160	10
55	(65)	240	90	60	35	65	120	R ^{1/4}	24	M20	80	145	180	10
60	70	240	90	60	35	70	120	R ^{1/4}	24	M20	80	145	180	10
70	80	270	100	70	45	80	140	R ^{1/4}	28	M24	90	165	210	10
(75)	90	300	100	80	45	85	160	R ^{1/4}	28	M24	100	185	240	10
80	90	300	100	80	45	90	160	R ^{1/4}	28	M24	100	185	240	10
90	100	330	120	90	45	100	180	R ^{1/4}	28	M24	100	195	270	10
90	110	330	120	90	45	100	180	R ^{1/4}	28	M24	100	195	270	10
100	(120)	360	120	100	50	115	200	R ^{3/8}	28	M24	110	215	300	11
110	125	360	120	100	50	125	200	R ^{3/8}	28	M24	110	215	300	11
125	140	410	140	100	55	140	220	R ^{3/8}	35	M30	120	235	330	11
140	160	440	160	100	60	155	240	R ^{3/8}	35	M30	130	255	360	11

Sizes in parentheses if possible avoid