

# SOPORTES DIN 504

según DIN 504

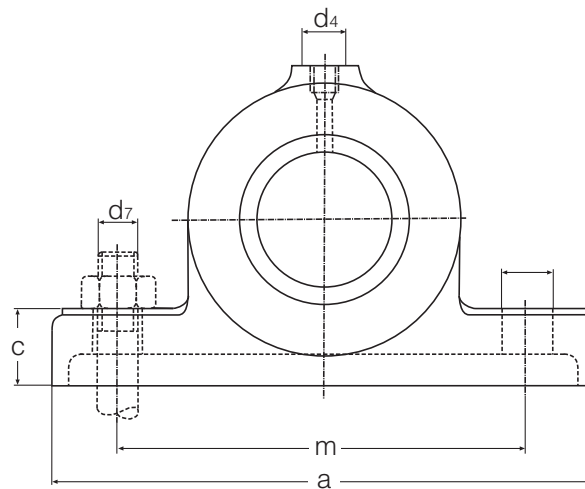

Ejecución A con casquillo

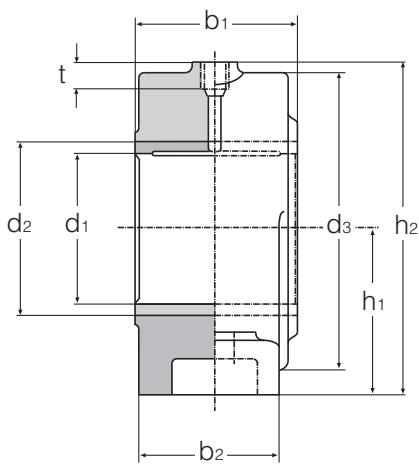

Ejecución B sin casquillo

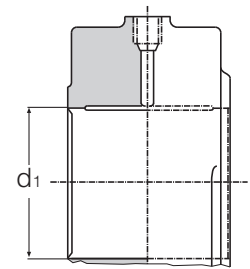

$d_1 / D_{10}$ A	$d_1$ B	a	$b_1$	$b_2$	c	$d_2$ mm	$d_3$	$d_4$	$d_6$	$d_7$	$h_1$ +/- 0,2	$h_2$ max	m	t
-	20	110	50	35	18	-	45	R 1/4	12	M10	30	56	75	10
-	25	140	60	40	25	-	60	R 1/4	15	M12	40	75	100	10
-	30	140	60	40	25	-	60	R 1/4	15	M12	40	75	100	10
25	35	160	60	45	25	35	80	R 1/4	15	M12	50	95	120	10
30	40	160	60	45	25	40	80	R 1/4	15	M12	50	95	120	10
35	45	190	70	50	30	45	90	R 1/4	19	M16	60	110	140	10
40	50	190	70	50	30	50	90	R 1/4	19	M16	60	110	140	10
45	55	220	80	55	35	55	100	R 1/4	24	M20	70	125	160	10
50	60	220	80	55	35	60	100	R 1/4	24	M20	70	125	160	10
55	(65)	240	90	60	35	65	120	R 1/4	24	M20	80	145	180	10
60	70	240	90	60	35	70	120	R 1/4	24	M20	80	145	180	10
70	80	270	100	70	45	80	140	R 1/4	28	M24	90	165	210	10
(75)	90	300	100	80	45	85	160	R 1/4	28	M24	100	185	240	10
80	90	300	100	80	45	90	160	R 1/4	28	M24	100	185	240	10
90	100	330	120	90	45	100	180	R 1/4	28	M24	100	195	270	10
90	110	330	120	90	45	100	180	R 1/4	28	M24	100	195	270	10
100	(120)	360	120	100	50	115	200	R 3/8	28	M24	110	215	300	11
110	125	360	120	100	50	125	200	R 3/8	28	M24	110	215	300	11
125	140	410	140	100	55	140	220	R 3/8	35	M30	120	235	330	11
140	160	440	160	100	60	155	240	R 3/8	35	M30	130	255	360	11

Se recomienda, evitar los tamaños entre paréntesis